



ALLENDALE TOWNSHIP SPORTS PARK

Sponsorship opportunities

Each of the posted levels of sponsorships include an engraved plaque that will be placed on a Sports Park Court as a permanent recognition of gratitude. A Diamond sponsor will include naming a court. In addition, an announcer ad with donors will be publicized. If a contribution is made of a lesser amount than the attached levels but exceeds \$500 your name/business name will be listed and appear on the community plaque for recognition. A community plaque will recognize all donors that contribute \$500-\$999.

PLEASE FILL OUT THE ATTACHED FORM WITH YOUR COMMITMENT.

PO Box 365
Allendale, MI 49401 (616)262-3791

Allendale Township Park Sports Park Sponsorship levels

Diamond Sponsor Naming Rights of a Court

\$7500 or Greater
Includes a 8X10"
Engraved Plaque

Gold Sponsor

\$5000 to \$7499
Includes a 8x10"
Engraved Plaque

Silver Sponsor

\$2500 to \$4999
Includes a 6X8"
Engraved Plaque

Bronze Sponsor

\$1000 to \$2499
Includes a 4X6"
Engraved Plaque

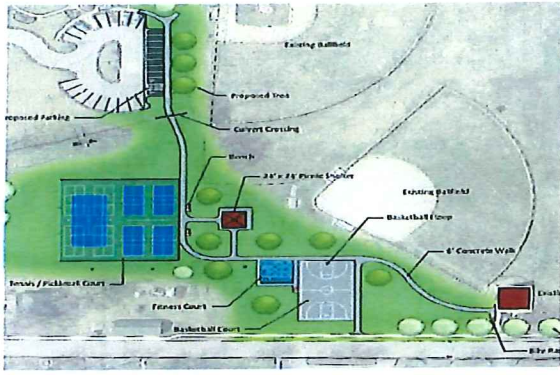

Allendale Community Sports Park

PO Box 365, Allendale, MI 49401

PH : (616)-262-3791

mhoekstra.trustee@gmail.com

SPORTS PARK SPONSOR FORM

Our company is pleased to support the Allendale Community Sports Park by a sponsorship grant at the level indicated below.

Sponsoring company/Person _____

Contact name _____

Address _____

Phone _____ Fax _____

Email _____

Please indicate the sponsorship level:

- DIAMOND- NAMING A COURT \$7,500 or greater (Limit 4)
- GOLD \$5,000 to \$7499
- SILVER \$2,500 to \$4999
- BRONZE \$1,000 to \$2499
- COMMUNITY SPONSOR \$ _____

Please choose the form of payment:

- Check (Make payable to the Allendale Community Foundation. Note: Sports Park in the memo line.)
- Credit Card
- Send an invoice

If by credit card, provide this information:

Card number: _____

Expiration date: _____

Holder's Name: _____ Holder's Signature: _____

Credit Card billing address:

Street address: _____

City: _____ State: _____ Zip code _____